

User Manual

Wall Lighting

Please read user manual before commencing installation and keep it for future reference.

■WARNING.

- 1.The safety of this lighting fixture is guaranteed only if you comply with these instructions.
- 2.Don' t connect these lighting fixtures to the mains supply directly, and please use the specific proper driver with specific input voltage.
- 3.The driver must be electronic switching power supply with constant voltage output,must not be magnetic transformer.
- 4.Please disconnect the power before repair,installation or replacement.
- 5.Please use the lights in the proper safe places as to avoid the lights be broken.
- 6.Whatever the case is, the lamp is not to be insulated liner or similar materials cover.
- 7.If any questions on this instruction,please consult a professional qualified technicians.

■Instructions of installation.

- 1.Ensure mains supply is switched off during the whole installation period.Disconnect the power supply to all of those units.
2. Please check below drawing and specifications.You should install the mounting box firstly during constructing the wall,and make the wires for the fixtures .
3. Connect the two wires to the wires from the driver with the waterproof connector IP65 at least in parallel circuit.
4. Push the fixture into the mounting box.
5. Ensure everything is installed very well,and then turn on the power for the application.

Note: The power of main supply must be switched off before connecting the cables.

■Specifications.

Item No.: Jupiter series

Input: AC12V

IP rating: IP65

Class: III

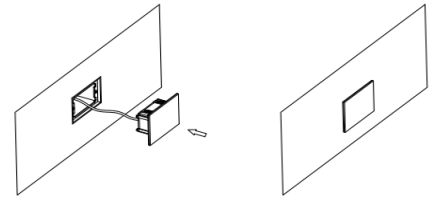

Jupiter 4A/Jupiter 3B

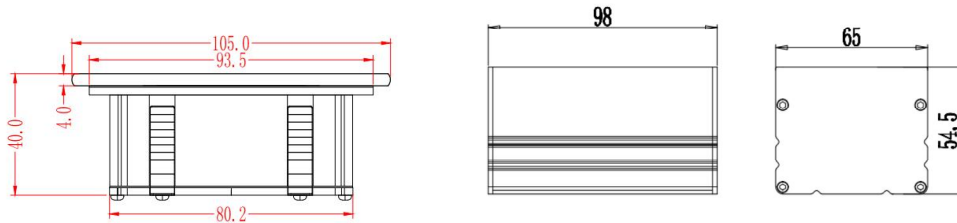

Jupiter 8A/Jupiter 5B

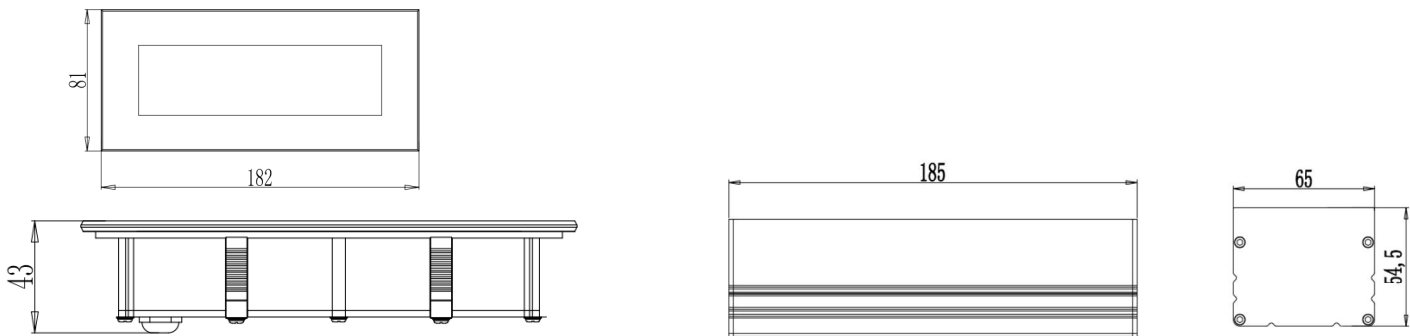

Warning.

The non-professionals can not disassemble or repair the fixture. We keep the right to refuse the replacement or repairing of the fixtures that have been disassembled or repaired personally.